

# MAGella<sup>®</sup>-Series

Magnetic flux filter

---

MAGella<sup>®</sup> MG100

MAGella<sup>®</sup> MG200

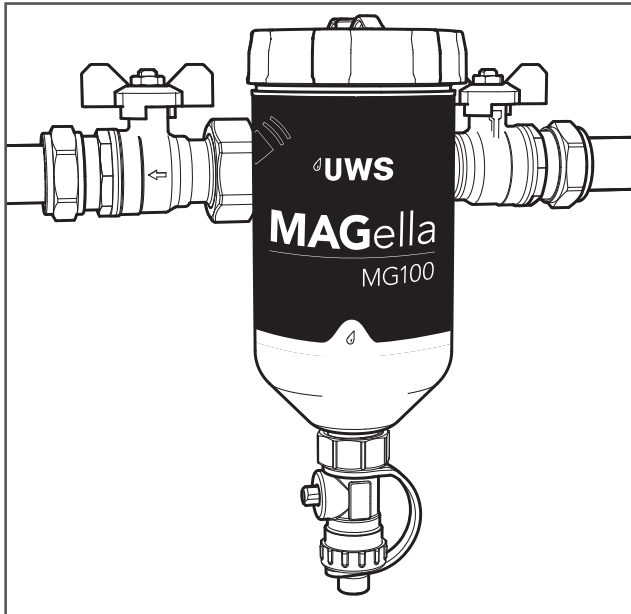

## Description

The MAGella MG100 and MG 200 magnetite filters remove all types of impurities that usually occur in heating systems. They protect the boiler and help maintain optimal operation and efficiency of the system.

Circulating impurities in heating systems can cause wear and premature failure of pumps, valves and heat exchangers. The MAGella MG100/MG200, mounted on the return line on the boiler, protects the system from all types of impurities. These filters are particularly suitable for systems with limited space.

MAGella filters use a unique magnetic core to achieve maximum contact time between the circulating impurities and the powerful neodymium-iron-boron magnets. The MAGella core reduces the water flow rate and turbulence within the unit to improve contaminant retention. It also ensures that the filter remains clog-free. The separated contaminants can be easily flushed out of the unit by removing the magnet from its collar and opening the drain valve on the bottom of the filter.

## Technical data

MAGella®	MG100	MG200
Item no.	MAG-100150	MAG-100160
Connections	with 3/4" IT	with 1" IT
Dimensions	205/76 mm (height/width)	228/88 mm (height/width)
Field strength	9,000 Gauß	9,000 Gauß
Max. Flow rate	32 l/min	50 l/min
Max. Temperature	100 °C	100 °C
Max. operating pressure	3 bar	3 bar
Mounting	Mount main unit upright only - Align flow with direction arrow	Mount main unit upright only - Align flow with direction arrow
Weight	1.3 kg (without packaging, incl. ball valve)	1.3 kg (without packaging, incl. ball valve)

## Safety instructions



### ATTENTION:

MAGella filters contain strong magnets. Stay away from electrical appliances, bank cards and other magnetic devices.



MAGella filters contain strong magnets. Handle with care if you are a pacemaker wearer.



MAGella filters are pressurised devices. The pressure must be released before any maintenance.



The units can become hot during normal operation. Please handle with care.

## Pressure loss curves

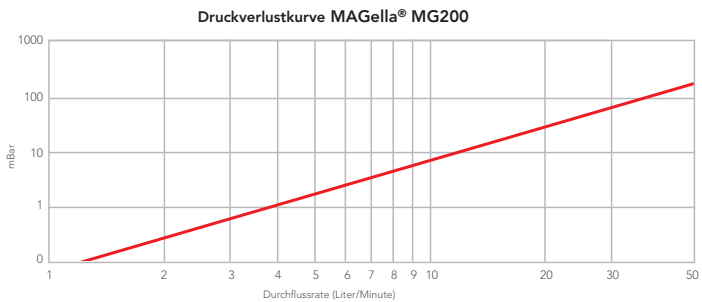
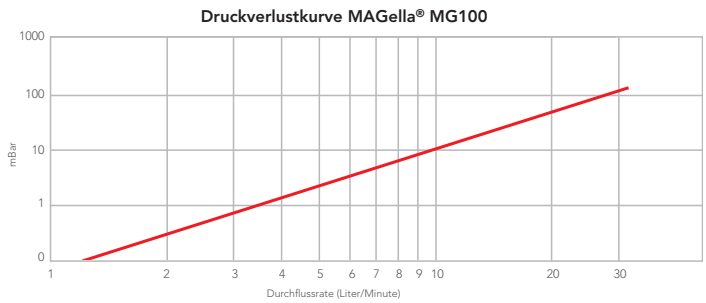

## Installation

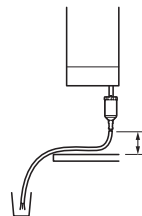
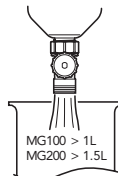
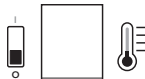
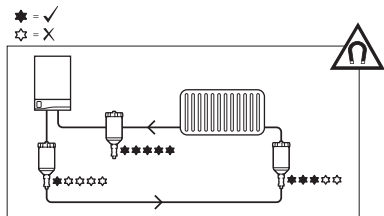
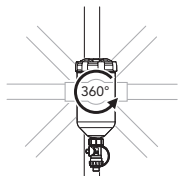
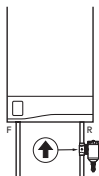

## Dimensions

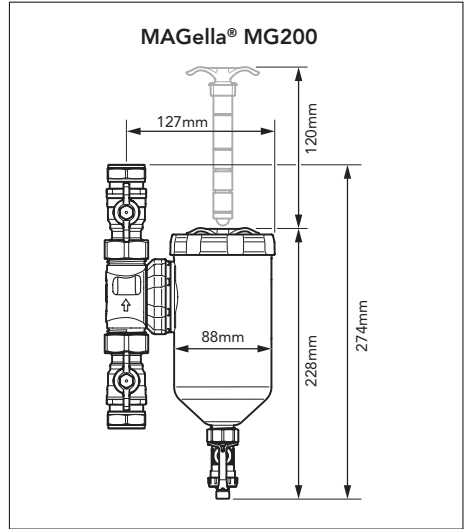
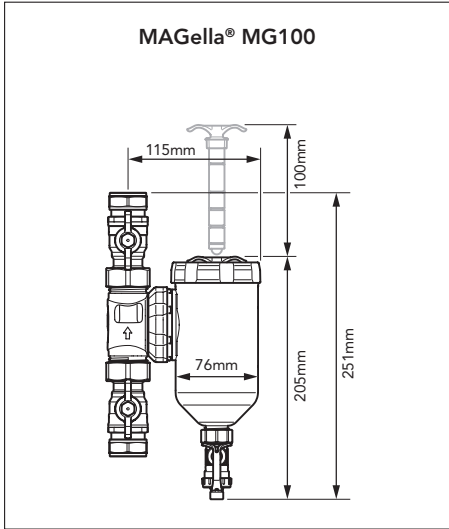

## Installation instructions



1"  
3/4"

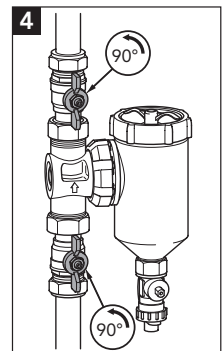
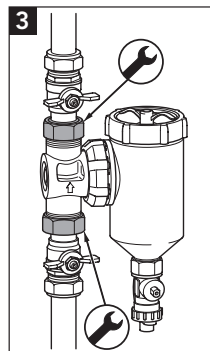
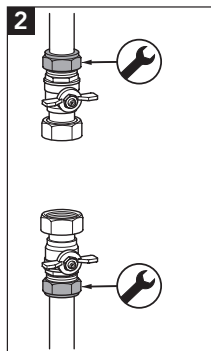
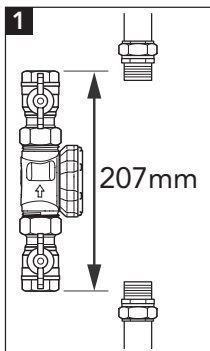
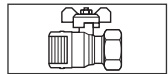

## Maintenance

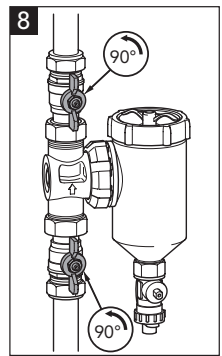
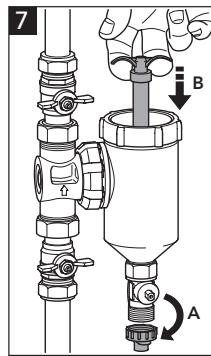
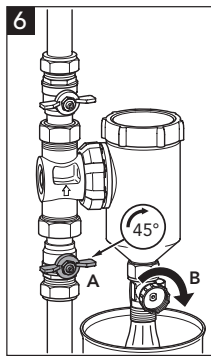
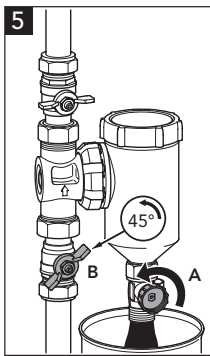
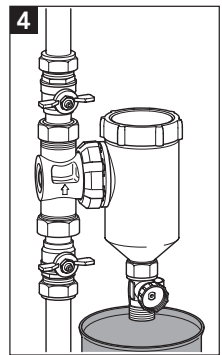
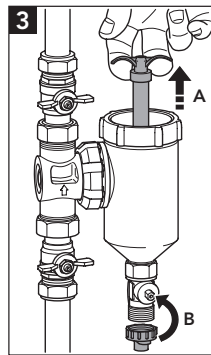
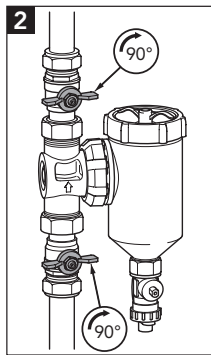
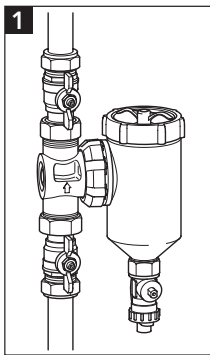

# our water. safe.

Your contact:

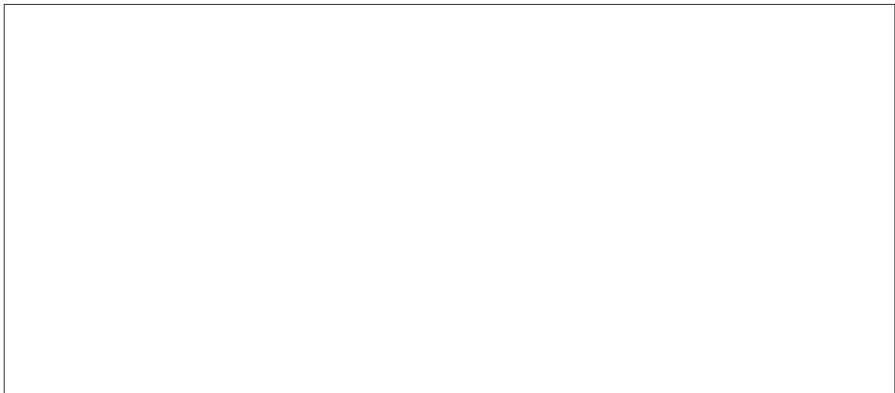

© UWS Technologie GmbH - All rights reserved

Version 1

Reprinting, including individual passages, is prohibited. The copyright and all rights are held by UWS Technologie GmbH. Translation, reproduction, storage and distribution, including transfer to electronic data carriers and storage in electronic media, is not permitted without prior written consent and is punishable by law.

No claims can be made on the basis of the information or illustrations provided.

We reserve the right to make changes in technology, form and equipment.

No liability is assumed for errors and misprints.

